



# YY-0221 Cube Case EEB3.0 version Technical Instruction

## I. INTRODUCTION

### 1. This Cabinet

YY-02XX is a server cabinet configured on PS2 power supply or a PS2 sized redundant power supply that takes using as a Server/Raid system. Compatible with extended ATX, ATX motherboard.

### 2. Component Checklist

If assembling this chassis by yourself, it is important to prepare all the chassis components before starting. This will save a great deal of time by not having to hunt down components. The following checklist provides a guideline as to the necessary components for a chassis.

#### Standard Components

- ✓ Chassis                    YY-0221
- ✓ Power Supply            PS2 PSU or Mini Redundant PSU

#### Optional required Components

- ✓ Cooling Fan              9cm cooling fan, 3pcs maximum
- ✓ Cooling Fan              12cm cooling fan, maximum 1pce
- ✓ EMI Filter                EMI filter for tailgates
- ✓ I/O Shield                Various I/O shield



## II. System Assembly and Disassembly

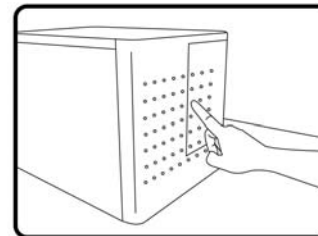

### 1. Front Panel

Push the door (pointed) to open the door for devices' operation.

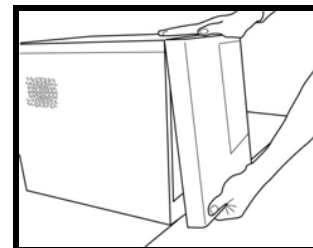

To assembly the front panel with plugging two hooks of the bottom of front panel, into the chassis body and snaps the springs of front panel in.

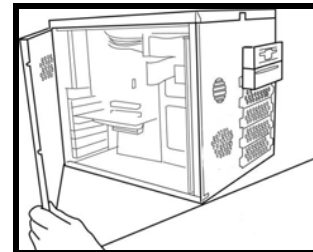

### 2. Side Panels

There are two screws in each side, release the screws, and open it like a door. There is a fan space in the side panel, integrator could figure it with or without fan depends on system's request.

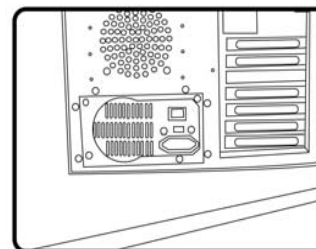

### 3. Power Supply Mounting

The chassis allows PS2 power supply with bracket or mini redundant power supply. Four screws are used to secure the power supply to the cabinet backside.

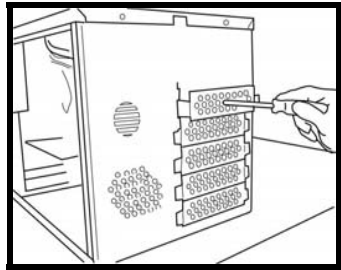

#### 4. Install Storage Devices

To install 5.25" HDD or CD-ROM, it should release the 5.25" device frame from the cabinet body first.

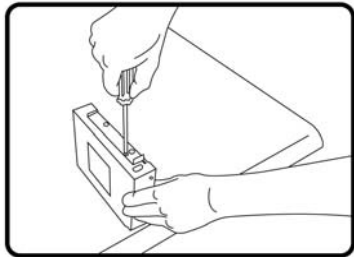

Take the metal slides out from 5.25" device frame, and ensure the metal slides should be fitted with device in position.

Press the device inward, to take the slides in along the rails of drive bay. Fasten by (2) screws on front side.

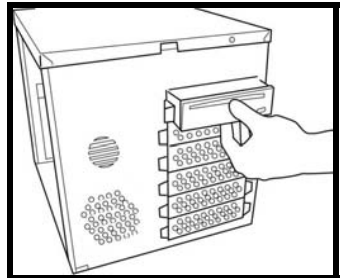

To install 3.5" HDD in the 5.25" drive bay, the metal shield could be screwed in the front end for better EMI result.

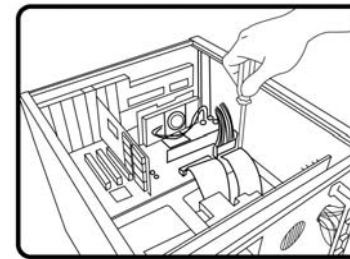
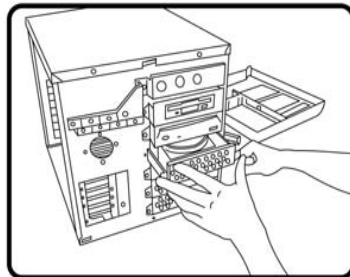
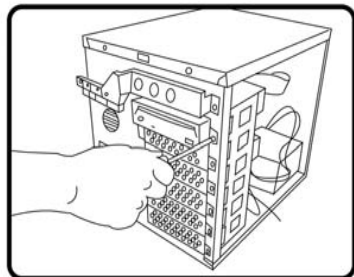

#### 5. Install motherboard & add-on-cards

Install I/O shield (putting from inside of case).

Finding correct mounting hole for M/B, screw in standoffs. Fasten M/B with the screw. Install add-on-cards.

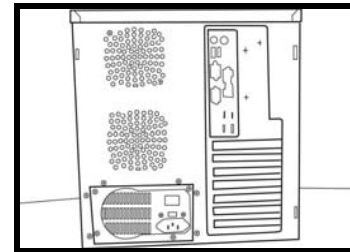

#### 6. Cooling Fan mounting

Front mounted: Fasten 12cm fan from outside of chassis by screw. Air flow out is stronger suggested.

Rear mounted: Fasten 9cm fans from outside of chassis by screws. Air flow in is stronger suggested.

Side mounted: Fasten 9cm fan from outside of chassis by screws. This vents could reserved as air flow in, no fan required. However, system integrator could re-build the air flow depends on system's configuration. A cooling fan could be installed in side cover, please watch out its cable routing when side cover assembly.

#### 7. Routing cables

#### 8. Close the chassis

Close the door. Snap in front panel without screw.